



SPACE DETAILS

ROOM INFORMATION & RENTAL FEES

The 200,000 square-foot Dena'ina Civic and Convention Center and its meeting rooms enhance the cultural experience both indoors and out, as well as provide the functionality and state-of-the-art technology expected from a premier meeting facility.

LOCAL BOOKINGS:

ADDRESS: 600 West Seventh Avenue, Anchorage, AK 99501
PHONE: 907-263-2850 **FAX:** 907-644-2842
EMAIL: info@anchorageconventioncenters.com
WEBSITE: www.anchorageconventioncenters.com

MEETING PLANNERS:

Please contact Visit Anchorage
EMAIL: 907-276-4118 | 888-257-2381 (toll-free)
WEBSITE: www.anchorage.net

CONTACT US!



**SAVOR...
ALASKA**

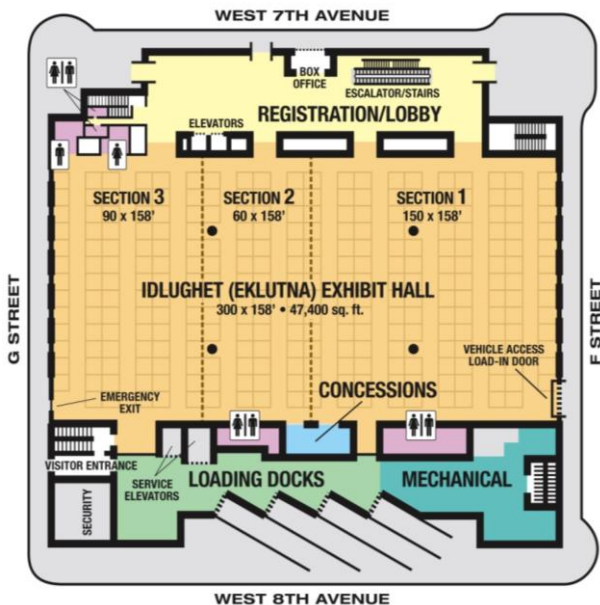

EXHIBIT HALL *street level*

IDLUGHET (EKLUTNA)

ROOM	SQ.FT.	THEATRE	CLASSRM.	BANQUET*	BOOTHS	ROOM RENTAL
Entire Hall	47,400	5,000	3,262	2,700	274	\$13,000
Section 1	23,700	2,500	1,631	1,290	137	\$6,500
Sections 1&2	33,180	3,486	2,336	1,770	195	\$8,900
Sections 2&3	23,700	2,500	1,631	1,290	137	\$6,500
Section 3	14,220	1,512	1,126	840	83	\$4,300

*10 guests per table

- Booth capacity based on standard 10 x 10 ft. booths
- Four loading docks/three at-grade delivery areas
- Drive-in/drive-out capability at multiple locations
- Service elevators: 12,000 lbs. and 20,000 lbs. capacity
- Floor to ceiling beam height: 30 ft.

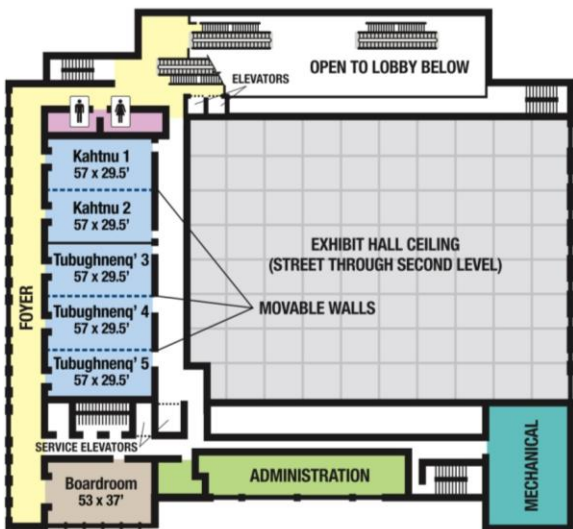

MEETING ROOMS second level

K'ENAKATNU (KNIK) EXECUTIVE BOARDROOM

KAHTNU (KENAI) ROOMS 1 & 2

TUBUGHNENQ' (TYONEK) ROOMS 3, 4, & 5

ROOM	SQ.FT.	THEATRE	CLASSRM.	BANQUET*	ROOM RENTAL
Room 1	1,746	173	80	80	\$540
Room 2	1,746	173	80	80	\$540
Room 3	1,750	173	80	80	\$540
Room 4	1,750	173	80	80	\$540
Room 5	1,750	173	80	80	\$540
Room 1 & 2	3,493	348	200	160	\$1,080
Rooms 3, 4, 5	5,252	522	320	280	\$1,620
Boardroom	1,987	198	108	90	\$725

*10 guests per table

- Meeting rooms – 11,000 sq. ft.
- Pre-function space – 2,700 sq. ft.
- Finished ceiling height – 13.6 ft.

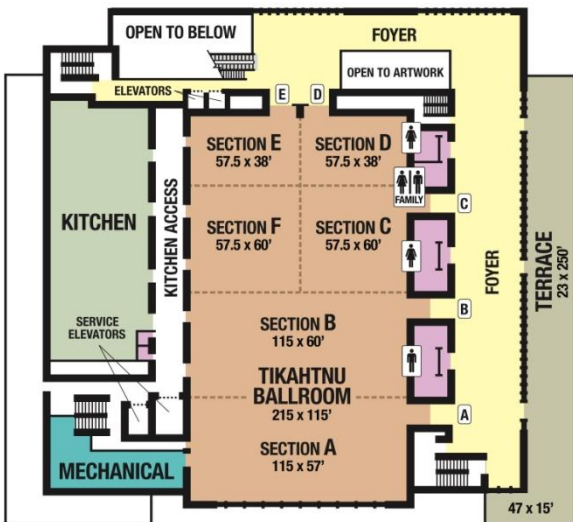

BALLROOM third level

TIKAHTNU (COOK INLET) BALLROOM

ROOM	SQ.FT.	THEATRE	CLASSRM.	BANQUET*	ROOM RENTAL
Full Ballroom	24,840	2,867	1,664	1,512	\$6,500
Section A	6,555	672	420	320	\$2,400
Section B	6,900	728	420	320	\$1,800
Section C	3,450	286	180	160	\$900
Section D	2,185	154	108	100	\$580
Section E	2,185	154	108	100	\$580
Section F	Must be combined with other Sections to allow for guest entry				
Section C&F	6,900	728	420	320	\$1,800
Section E&F	5,635	598	288	280	\$1,480
Terrace	6,110	Accommodates up to 900, event - dependent			\$1,500

*10 guests per table

- Space will accommodate up to 116 standard 10 x 10 ft. booths
- 15,000 sq. ft. pre-function lobby space
- State-of-the-art kitchen may support 5,000+ person events
- In-house catering by Savor...Alaska
- Unparalleled vistas of the Chugach Mountain Range
- 30 ft. high beamed ceiling allows for specialty lighting and sound installation