

ANCHORAGE CONVENTION CENTERS



ELEVATE
your
image

ANCHORAGE CONVENTION CENTERS



DENA'INA CIVIC AND CONVENTION CENTER



The new jewel in Anchorage's expanding crown, Dena'ina is a triumph of high northern latitude design. The natural light reflecting through the building is brilliant, the views from the Ballroom overlooking the Chugach Mountain range are dazzling and the Alaska Native artwork throughout the facility honoring the original Athabascan settlers of the region is stunning.

The 200,000-square-foot facility and its meeting rooms enhance the cultural experience both indoors and out, as well as provide the functionality and state-of-the-art technology expected from a premier meeting facility.

visit  anchorage
big wild life



WILLIAM A. EGAN CIVIC & CONVENTION CENTER



Flexible, attractive and economical, the Egan Center is rich in features and offers downtown Anchorage perfection for a modest price.

Named after Alaska's first governor, Egan is host to a multitude of meetings and events throughout the year, ranging from small, intimate local groups to large-scale, multiple-day conventions. With more than 85,000 square feet of meeting, exhibit and pre-function spaces, built-in design features provide all the necessities and conveniences necessary to produce a successful gathering.

Located in the heart of Anchorage, the Egan Center is adjacent to the Alaska Center for the Performing Arts, Town Square Park and is just two blocks from its larger sister facility, the Dena'ina Center.



EAT. DRINK. SAVOR...

fabulous food & beverage

DELICIOUS, FRESH, LOCAL CUISINE

Great food prepared with care and served with a smile is a key ingredient to a successful event. Our menu options are extensive and the skills of our kitchen staff are first class. Call one of our event planners today to help set the table for your group.



YOUR PLACE OR OURS: THE AWARD-WINNING CUISINE OF SAVOR... ALASKA IS AVAILABLE ON DEMAND.

Whether it's lunch for 50 or dinner for 5,000, the culinary team at Savor... Alaska can deliver. Ask us about our off-site catering services.

SAVOR... ALASKA



EFFERVESCENT *service*

FROM INTIMATE TO MAJESTIC, WE'RE HERE TO SERVE

We invite you to come experience the warmth of our hospitality. The team at the Anchorage Convention Centers stands ready to make your next event a sparkling success.



ELEGANT *options*

FOR YOUR SPECIAL EVENTS

Intimate gatherings are a familiar sight in the Anchorage Convention Centers. We can provide the ambiance and the attention to detail you need for a stylish wedding or a high-profile corporate celebration. If first-class options are what you need—we can do that!



SOARING *art & architecture*

AN INSPIRATIONAL SETTING

The cultural heritage of the first Alaskans dates back 10,000 years. The spirit of the Dena'ina people is reflected in the stained glass murals, expansive open spaces and traditional carvings on display throughout both venues. Recognition of the Dena'ina legacy is also expressed in the designation of the Center's five main areas: spaces from the Ballroom and Executive Boardroom to meeting rooms and the grand 50,000-sq.-ft. Exhibit Hall are Dena'ina place names.



OCCASIONS *great & small*

CELEBRATE IN OUR HOUSE

Family traditions run deep in Alaska. A shared meal is a gift to be cherished. Whether you're seven or 70, celebrating a birthday or anniversary, we have the perfect setting to complement your mood and your budget. Come, celebrate in our house.



HIGH *definition*

WIRELESS & MORE!

All Dena'ina meeting rooms have built-in, high definition ceiling projectors and retractable screens. Wireless internet is available throughout the facilities. Custom lighting options and configurations are available as well as programmable skylight and window shade control settings.

STUNNING *views*

SOAK IN THE PANORAMIC VISTAS

Throughout the seasons, visitors and guests can enjoy the ever-changing scenery that surrounds Anchorage: the Alaska Range and Cook Inlet to the west, Denali to the north and our local playground, the Chugach Range to the south and east.

DENAINA *civic and convention center*

FACILITY OVERVIEW

EXHIBIT HALL STREET LEVEL IDLUGHET (EKLUTNA)

ROOM	SQ. FT.	THEATRE	CLASSRM.	BANQUET*	BOOTHS
Entire Hall	47,400	5,000	3,262	3,240/2,700	274
Section 1	23,700	2,500	1,631	1,548/1,290	137
Sections 1&2	33,180	3,486	2,336	2,124/1,770	195
Sections 2&3	23,700	2,500	1,631	1,548/1,290	137
Section 3	14,220	1,512	1,126	1,008/840	83

*12/10 per table

- Booth capacity based on standard 10 x 10 ft. booths
- Four loading docks/three at-grade delivery areas
- Drive-in/drive-out capability at multiple locations
- Service elevators: 12,000 lbs. and 20,000 lbs. capacity
- Floor-to-ceiling beam height: 30 ft.

MEETING ROOMS SECOND LEVEL

K'ENAKATNU (KNIK) EXECUTIVE BOARDROOM

KAHTNU (KENAI) ROOMS 1 & 2 = TUBUGHNENQ' (TYONEK) ROOMS 3, 4 & 5

ROOM	SQ. FT.	THEATRE	CLASSRM.	BANQUET (12/10 per table)
Room 1	1,746	173	80	96/80
Room 2	1,746	173	80	96/80
Room 3	1,750	173	80	96/80
Room 4	1,750	173	80	96/80
Room 5	1,750	173	80	96/80
Rooms 1 & 2	3,493	348	200	192/160
Rooms 3,4,5	5,252	522	320	336/280
Board Room	1,987	198	126	108/90

- Meeting rooms - 11,000 sq. ft.
- Pre-function space - 2,700 sq. ft.
- Finished ceiling height - 13.6 ft.

BALLROOM THIRD LEVEL TIKAHTNU (COOK INLET) BALLROOM

ROOM	SQ. FT.	THEATRE	CLASSRM.	BANQUET (12/10 per table)
Full Ballroom	24,840	2,867	1,664	1,812/1,510
Section A	6,555	672	420	384/320
Section B	6,900	728	420	384/320
Section C	3,450	286	180	192/160
Section D	2,185	154	108	120/100
Section E	2,185	154	108	120/100
Section F	Section F must be combined with other sections to allow for guest entry			
Section C&F	6,900	728	420	384/320
Section E&F	5,635	598	288	336/280
Terrace	6,110	Accommodates up to 900, event-dependent		

- Space will accommodate up to 116 standard 10x10 ft. booths
- 15,000 sq. ft. pre-function lobby space
- State-of-the-art kitchen can support 5,000+ person events
- In-house catering by **Savor... Alaska**
- Unparalleled vistas of the Chugach Mountain Range
- 30-ft.-high beamed ceiling allows for specialty lighting and sound installation

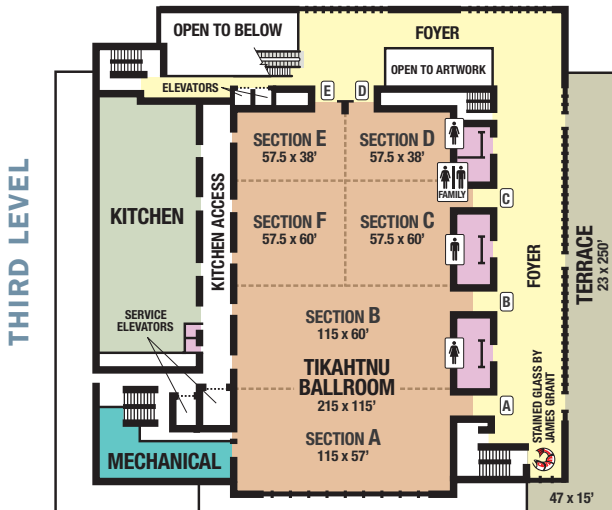
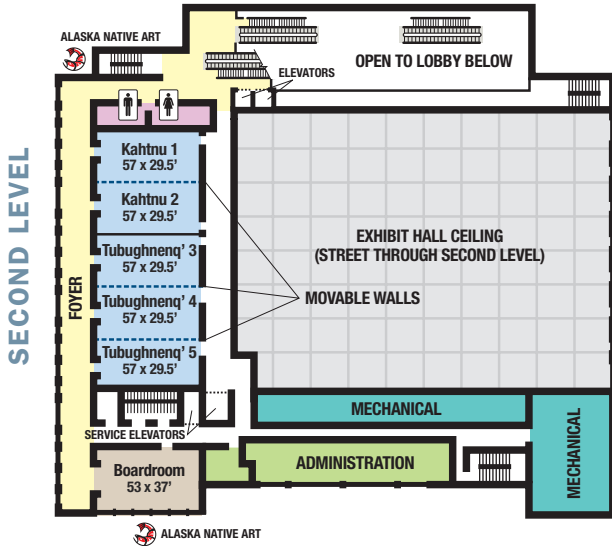
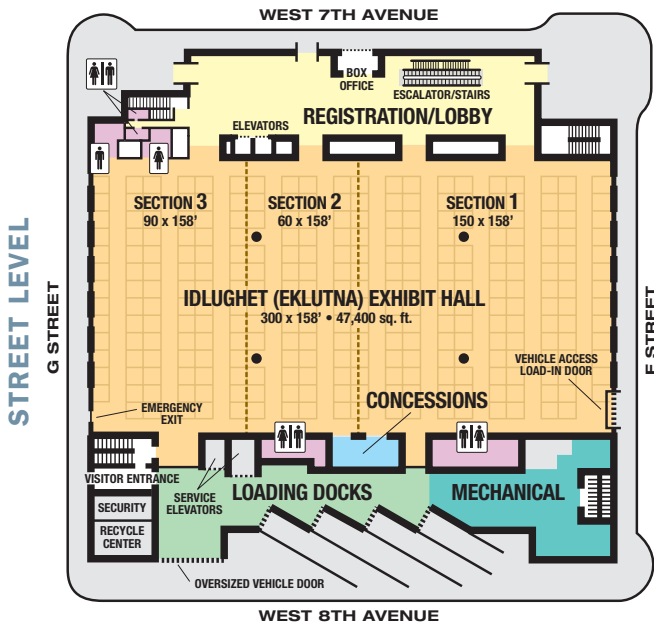

EGAN *civic & convention center* FACILITY OVERVIEW

EXPLORERS HALL STREET LEVEL

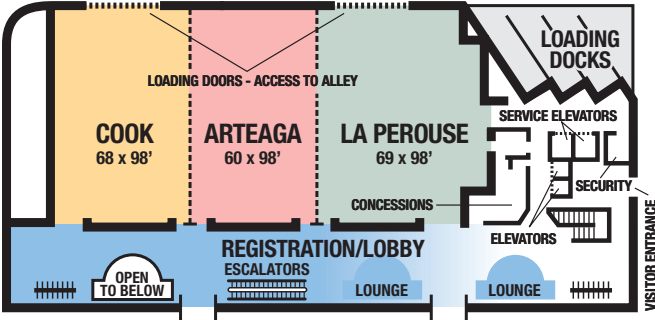

ROOM	SQ. FT.	THEATRE	CLASSRM.	BANQUET (12/10 per table)
Entire Hall	19,306	2,540	1,400	1,536/1,280
Cook Hall	6,664	850	500	480/400
Arteaga Hall	5,880	700	400	384/320
LaPerouse Hall	6,762	850	500	480/400

- Space will accommodate up to 132 standard 8x10 ft. booths
- Facility designed to allow streamlined loading and unloading
- Recessed metal halide and incandescent lighting
- Fabric-covered moveable walls with sound dampening
- All three Hall floors are carpeted
- 24-foot-high finished ceiling with targeted track lighting

SUMMIT HALL LOWER LEVEL

ROOM	SQ. FT.	THEATRE	CLASSRM.	BANQUET (12/10 per table)
Entire Hall	11,228	1,400	680	880/704

- Highly flexible: Divides into up to 14 breakout rooms of 570 to 1,368 sq. ft. and any combination thereof

Space 1	1,368	130	64	72/60
Space 2	1,140	100	64	72/60
Space 3	1,140	100	64	72/60
Space 4	1,140	100	64	72/60
Space 5	826	60	32	48/40
Space 6	826	60	32	48/40
Space 7	570	40	32	24/20
Space 8	570	40	32	24/20
Space 9	570	40	32	24/20
Space 10	570	40	32	24/20
Space 11	570	40	32	24/20
Space 12	570	40	32	24/20
Space 13	570	40	32	24/20
Space 14	798	60	48	48/40
O'Malley	368	20	16	24/20
Spurr	315	20	16	24/20

- Space will accommodate up to 65 standard 8x10 ft. booths
- Recessed lighting with individual controls
- Fabric covered moveable walls with sound dampening
- Completely carpeted floors and 12-foot finished ceiling

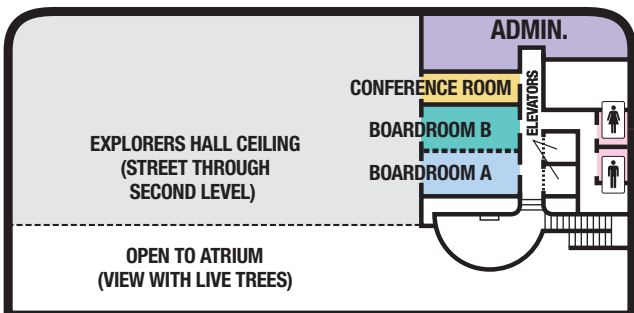
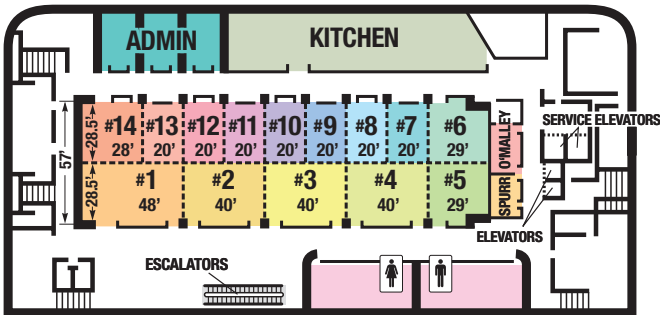

BOARDROOM UPPER LEVEL

ROOM	SQ. FT.	THEATRE	CLASSRM.	BANQUET (12/10 per table)
Boardrm. A&B	946	80	60	72/60
Boardroom A	559	40	32	48/40
Boardroom B	387	20	16	24/20
Conference Rm.	355	Ten person table		

- Finished ceiling height - 9 ft.

ANCHORAGE CONVENTION CENTERS

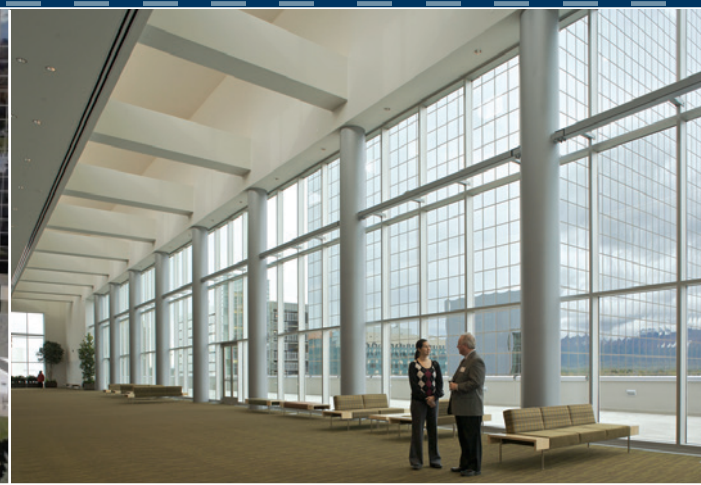

ENHANCE *your* event

**Breakfasts
Luncheons
Dinners
Auctions
Meetings
Seminars
Presentations
Trade Shows
Concerts
Weddings
Special Occasions
Events**

...and of course:
Conventions!

- The Denaina Civic and Convention Center includes 11,200 cubic yards of concrete – the equivalent of a five-foot-wide sidewalk from Anchorage to Wasilla
- Idlughet (“ee-DLOW-ghut”) Exhibit Hall is 50,000 sq. ft. – equivalent to a football field minus the end zones
- The Denaina Civic and Convention Center construction included the use of 2,600 tons of structural steel – the equivalent of 1,200 pickup trucks
- One of the two service elevators is large enough to hold an African elephant
- The outdoor terrace, which can accommodate 900 guests, has a heated floor for year-round use and offers gorgeous mountain views
- The state-of-the-art kitchen includes a flight-type dishwasher that can clean and sanitize up to 15,700 plates per hour
- Two “on demand” kitchen coffee machines are capable of brewing up to 9,576 cups per hour
- 2,781 indoor parking spaces within two blocks and metered street parking throughout downtown

 [AnchorageConventionCenters](https://www.facebook.com/AnchorageConventionCenters)
facebook.com/DenainaCenter facebook.com/EganCenterAlaska

 [AnchorageConventions](https://www.youtube.com/AnchorageConventions)

SMOOTH *logistics*

EXCEPTIONAL ACCESS

- **Event load-in** Continuous drive thru vehicle access—in the front door, out the side! Four oversized truck bays with expediter staging area.
- **Attendee and guest arrival** Accommodates four full-size motor coaches for event drop off. Low volume, two-way street traffic. Nearby parking ramps, and walking distance to major hotels.

Contact us today!

Find out more at anchorageconventioncenters.com

Local bookings:

Contact the Anchorage Convention Centers staff at (907) 263-2850
Denaina Center: 600 West Seventh Avenue, Anchorage, AK 99501
Egan Center: 555 West Fifth Avenue, Anchorage, AK 99501

Meeting planners:

Contact Visit Anchorage (formerly known as the *Anchorage Convention & Visitors Bureau*) at (907) 276-4118 or toll-free at (888) 257-2381 or visit anchorage.net

